

ALTRA





CHARACTERISTICS – LUMINAIRE

Tightness level:	IP 65 ^(*) (option: IP 66 ^(*))
Aerodynamic resistance (CxS):	
- Altra 2:	0,044 m ²
- Altra 3:	0,050 m ²
Impact resistance (PC/PMMA):	IK 08 ^(**)
Electrical insulation class:	I ^(*)
Weight (empty):	
- Altra 2:	3,8 kg
- Altra 3:	4,3 kg

^(*) according to standard IEC - EN 60598

^(**) according to standard IEC - EN 62262

ADVANTAGES

- High photometric performance
- Economical installation and energy costs
- Robustness and longevity



DESCRIPTION

Public lighting luminaire, for low-pressure sodium and compact fluorescent lamps.

The Altra luminaire consists of a body made of die-cast aluminium alloy, painted grey and a black polypropylene cover, treated to withstand UV rays.

The optical compartment consists of a white lacquered metallic reflector holding the lampholder support and the lamp, and a prismatic refractor made of polycarbonate, treated to withstand UV rays, or of acrylic. The control gear is attached to the back of the reflector.

Vertical or side-entry mounting by means of a hinged door / clamp.

Coating: polyester powder

Colour: RAL grey 7038

OPTIONS

- Any RAL or AKZO colour for the aluminium body
- Powder coated aluminium cover
- Powder coated aluminium clips
- Reflector tilting around a hinge, tool-free operation
- Aluminium bracket for wall mounting
- Louvres
- Pedestrian crossing asymmetric reflector
- Bi-power electronic ballast
- Photocell
- Side-entry mounting Ø48 mm
- 18W compact fluorescent lamp version

EXTENSIVE SPACING

Thanks to the prismatic refractor, Altra luminaires can be installed with greater spacing, while maintaining high levels of luminance uniformity.

FLEXIBILITY OF INSTALLATION

The Altra luminaire is fitted with a mounting system with a hinged door / clamp, allowing side-entry or vertical mounting for several diameters of poles or brackets.

ALMOST CONSTANT LUMINOUS FLUX

Fitted with an acrylic cap, the compact fluorescent lamps maintain an almost constant luminous flux, even at low temperatures.

DIMENSIONS - MOUNTINGS

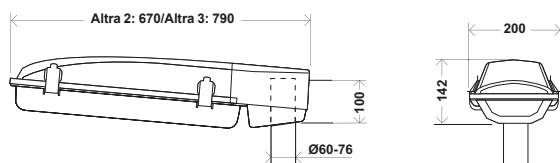

Vertical or side-entry mounting by means of a hinged door / clamp, making it simple to change from one mounting possibility to the other.

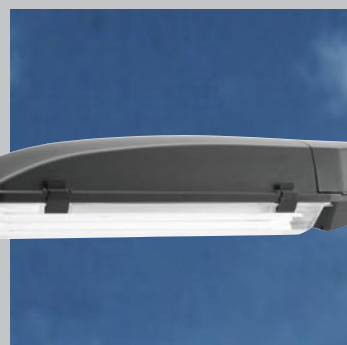
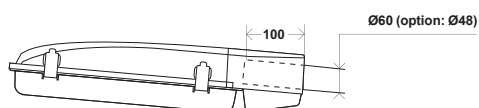

ALTRA

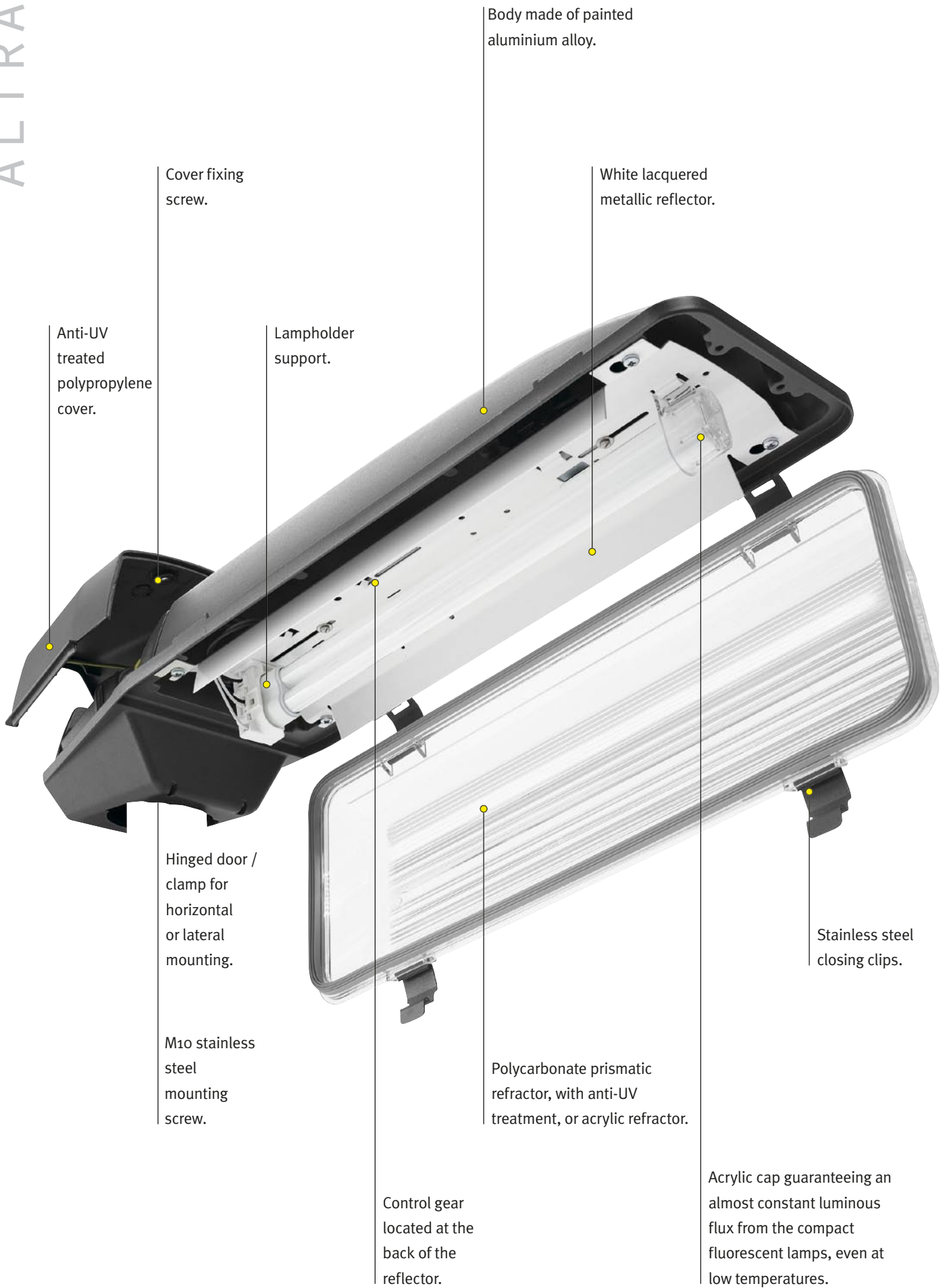

Anti-UV treated polypropylene cover.

Cover fixing screw.

Lampholder support.

Body made of painted aluminium alloy.

White lacquered metallic reflector.

Hinged door / clamp for horizontal or lateral mounting.

M10 stainless steel mounting screw.

Control gear located at the back of the reflector.

Polycarbonate prismatic refractor, with anti-UV treatment, or acrylic refractor.

Acrylic cap guaranteeing an almost constant luminous flux from the compact fluorescent lamps, even at low temperatures.

Stainless steel closing clips.

PHOTOMETRY



ALTRA 2 LAMPS - REFLECTOR

Reflector	Low-pressure sodium				Compact fluorescent	
	26 W	35 W	36 W	55 W	24 W	36 W
1618	✓	✓	✓	✓	✓	✓

Low-pressure sodium | Comp. fluo.

PHOTOMETRIC DISTRIBUTION

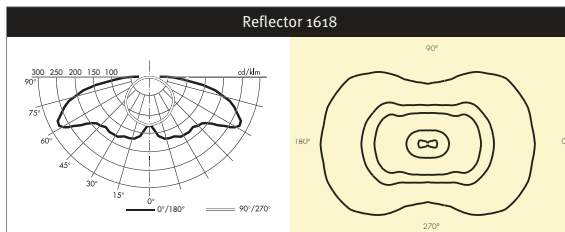

ALTRA 3 LAMPS - REFLECTOR

Reflector	Low-pressure sodium					Compact fluorescent			
	26 W	35 W	36 W	55 W	66 W ⁽¹⁾	36 W	40 W	55 W	80 W
1618	✓	✓	✓	✓	✓	✓	✓	✓	✓

⁽¹⁾ only with electronic control gear

Low-pressure sodium | Comp. fluo.

PHOTOMETRIC DISTRIBUTION

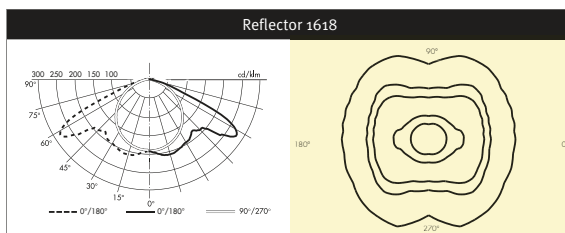

ALTRA
Hoofddorp
The Netherlands



ALTRA
Heemstede
The Netherlands



FLEXIBILITY AND EXTENSIVE SPACING

ALTRA
Den Haag
The Netherlands





THE RIGHT LIGHTING